

MELBOURNE 9/30 Queens Road

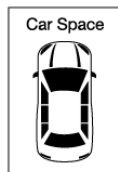

CAYZER

MELBOURNE 9/30 Queens Road

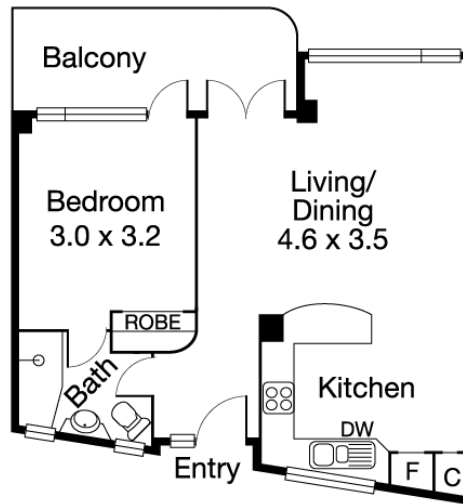

(Not To Scale and
Not In Position)

NEWBURN FLATS - MID CENTURY CLASSIC

- Wonderful proximity to city/beach-bound trams via St Kilda Rd, Albert Park Lake, Fawkner Park and seaside precincts
- Secure intercom entry and a communal coin-operated laundry
- One car space

Revealed within magnificent Romberg & Sham designed block is this impressive apartment, comprises: Sunny lounge with oversized windows, well presented kitchen and meals area, a generous bedroom with built in robes, a stylish bathroom plus a large balcony.

🛏 1 🚿 1 🚗 1

PRIVATE SALE

Inspection As advertised or by appointment

Contact Charlotte Broussard 0403 451 899
Simon Carruthers 0438 811 601

Mel Ref 57 K4



CAYZER

Albert Park 330 Montague Street 03 9699 5999
Port Melbourne 370 Bay Street 03 9646 0812

cayzer.com.au

Every care has been taken to ensure the information contained in this document is accurate. The diagrams/plans are a representation only and are not to scale. Interested parties should seek independent legal advice. Cayzer Real Estate Pty Ltd does not accept any responsibility or liability as a result of the information provided in this document. If your property is currently listed for sale with another agent, please disregard this notice. | Cayzer Real Estate Pty Ltd |